

1.

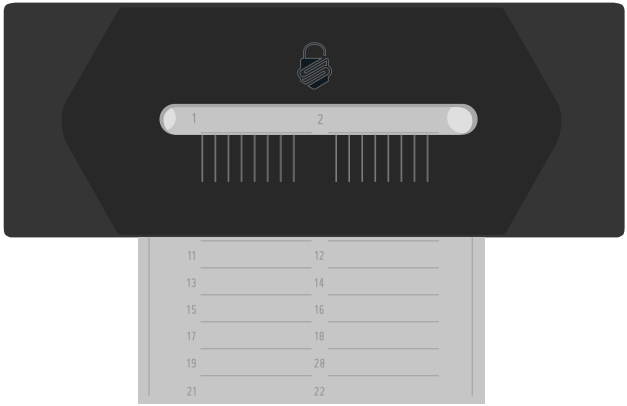

SLIDE PLATE INTO JIG ENSURING BOTTOM LINE OF ROW IS ALIGNED WITH BOTTOM OF JIG WINDOW.

2.

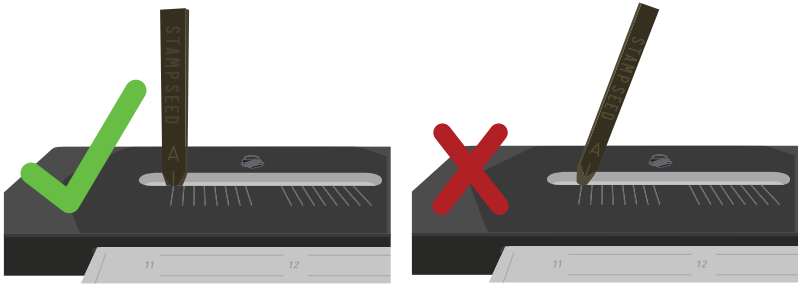

ALIGN INDICATOR LINE ON STAMP WITH LINE ON JIG AND AIM TO FORM A 90 DEGREE ANGLE. ENSURE BOTH LINES TOUCH - NO GAPS.

3.

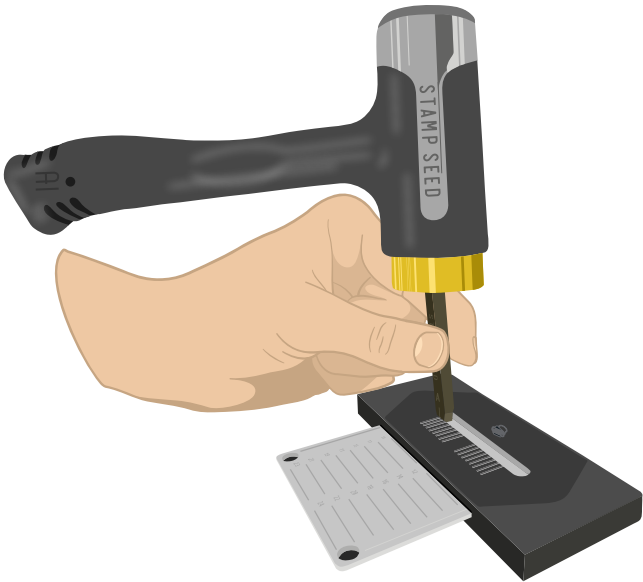

HAMMER STAMP 1-2X KEEPING STAMP IN PLACE BETWEEN SWINGS.

FOR DEEPER STAMPINGS EITHER:
A. INCREASE FORCE
B. FIND A MORE SOLID SURFACE
C. USE A HEAVIER HAMMER

4.

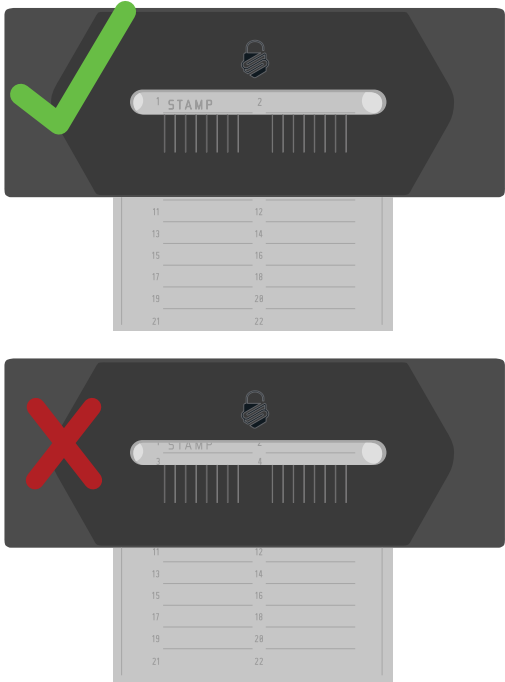

MOVE TO NEXT POSITION ENSURING PLATE IS STILL ALIGNED. CONTINUE TO STAMP REMAINDER OF SEED WORDS.

5.

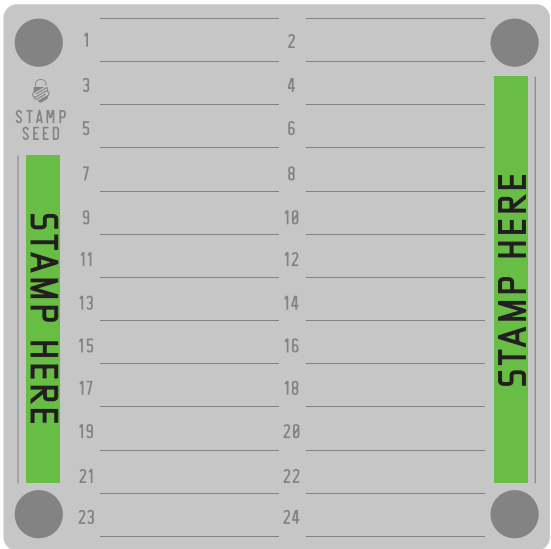

STAMP ADDITIONAL INFORMATION (WALLET, PIN CODE, ETC), ON SIDE LINES BY ROTATING PLATE AND SLIDING BACK INTO JIG.

6.

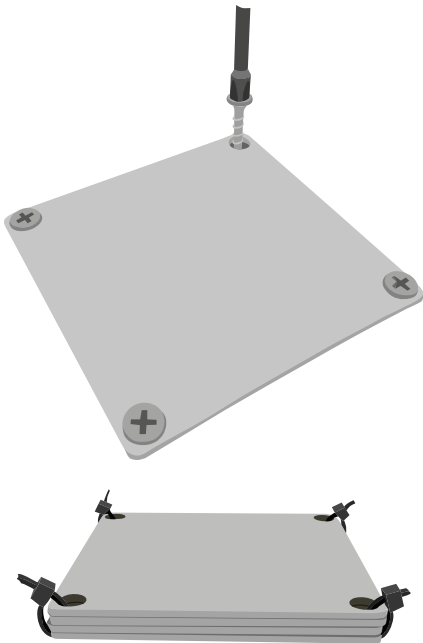

CORNER HOLES CAN BE USED TO SECURE TO A SURFACE USING SCREWS/NAILS, OR STACK MULTIPLE PLATES TOGETHER WITH LOCKS, ZIP TIES, OR HARDWARE (NOT INCLUDED).